

## Berkshire Ornithological Club Queen Mother Reservoir access

Thames Water offers access at Queen Mother Reservoir for bird-watching through the Berkshire Ornithological Club under the conditions of a Thames Water Operational Safety Authorisation and license issued to the Club. The Berkshire Ornithological Club may issue permits to its members and may withdraw the permit without notice if the conditions of issue are breached. Access is permitted from dawn to one hour after sunset to the area around the sailing club and to the perimeter pathway only (the wave wall and grass banks are out of bounds).

The walk around the perimeter of the reservoir is approximately 5 km, with no shelter. Visitors should ensure that they are appropriately dressed and equipped for the prevailing weather conditions, which can be very cold with strong wind exposure in winter: warm waterproof clothing is recommended. In summer, hats and sunscreen may be needed. There is no drinking water available around the perimeter, so an adequate supply should be taken. There are no toilet facilities around the reservoir and urination on the site is strictly prohibited. Please ensure that no litter is left anywhere within the reservoir site.

The Datchet Sailing Club has said that, when the clubhouse is open, birdwatchers may use its toilet facilities; its café, open Wednesday, Saturday, Sunday, may also be used.

Thames Water is responsible for security of this sensitive site: please ensure that you lock gates securely immediately after you and that you do not encourage or allow non-permit holders to access the site. Any suspicious behaviour should be reported immediately to Thames Water's helpline (0845 920 0800; please quote bulletin board number 837729).

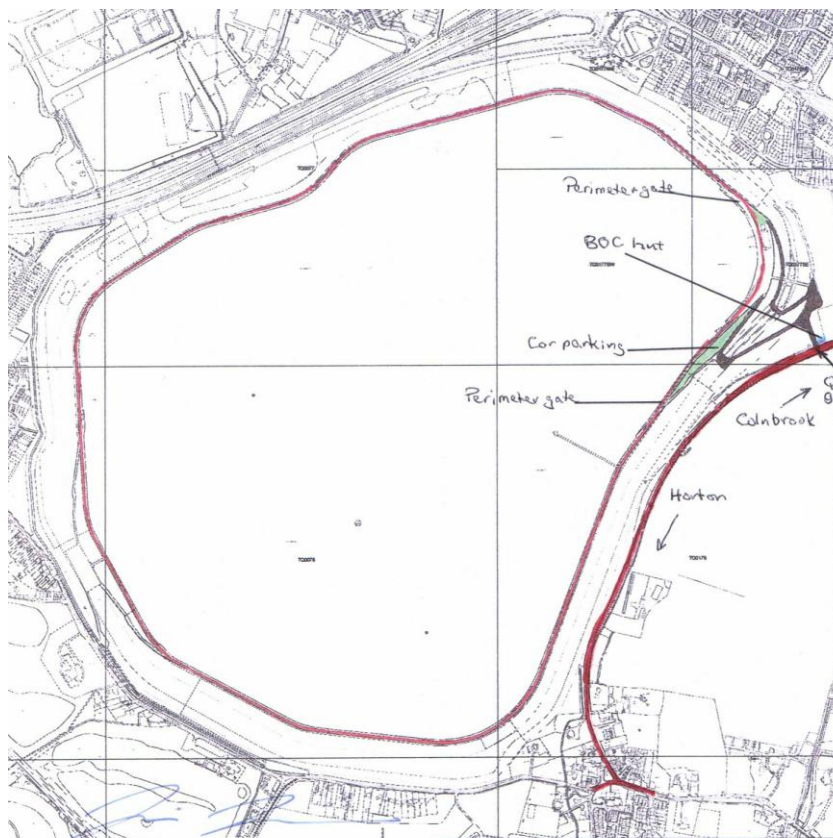

For access from the M4, take exit 5, then A4 towards Colnbrook. After about 200m turn right following signs to Colnbrook. At the village, follow the main road sharply to the right along the eastern side of the reservoir. The second gate on the right hand side gives access to the reservoir (at TQ016,769).

The BOC entrance is on the right side and has a combination lock panel. Please ensure that the chain is correctly replaced around both gates and the hasp inserted securely in the lock immediately after entry or exit. The gate may not be left open unattended at any time.

Permit holders must **sign in at the BOC hut**, which is immediately on the right of the gate and can be entered using the combination code provided. Cars should then be parked on the car parking on either side of the sailing club building. Please record bird observations in the log book provided in the hut.

If the BOC gate is unavailable (we will endeavour to give notice should this happen), permit holders may enter via the sailing club barrier, which is open during sailing club hours (9-5, closed Mondays). Exit passes to open the barrier can be obtained from the sailing clubhouse.

Enquiries to: Renton Righelato, BOC, 63 Hamilton Road, Reading, RG1 5RA; email [renton.righelato@berksoc.org.uk](mailto:renton.righelato@berksoc.org.uk)